

Welding Neck Orifice Class 1500

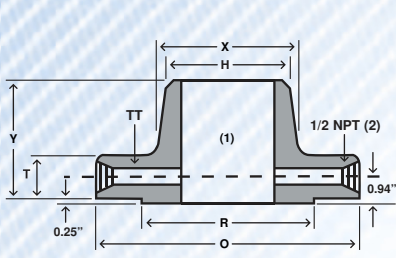

RAISED FACE



SPECIAL 1 OR 2 PIECE RING AND ORIFICE PLATE ASSEMBLY

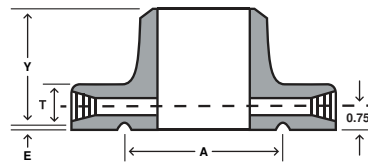

RING TYPE JOINT

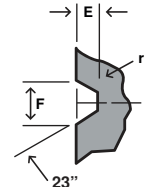

GROOVE DETAIL

	Nom Size								Drilling				Ring Type Joint					
		OD	Thickness	OD of RF	Dia at Base	Dia Bevel	LTH	Dia of Pressure Connection	Bolt Circle	Hole Dia	# of holes	Bolt Dia	Grove #	Pitch Dia	Groove Depth	Groove Width	Rad at Bottom	Spec Oval RH
		O	T	R	X	H	Y	TT					P	E	F	r max	W	
in	1	5.88	1.50	2.00	2.06	1.32	3.25	1/4	4.00	1.00	4	7/8	R16	2.000	0.250	0.344	0.03	1.00
mm		149.4	38.1	50.8	52.3	33.5	82.6	6.4	101.6	25.4	4	22.2	50.800	6.350	8.738	0.8	25.4	
in	1 1/2	7.00	1.50	2.88	2.75	1.90	3.50	1/4	4.88	1.12	4	1	R20	2.688	0.250	0.344	0.03	1.00
mm		177.8	38.1	73.2	69.9	48.3	88.9	6.4	124.0	28.4	4	25.4	68.275	6.350	8.738	0.8	25.4	
in	2	8.50	1.50	3.62	4.12	2.38	4.00	1/4	6.50	1.00	8	7/8	R24	3.750	0.312	0.469	0.03	1.06
mm		215.9	38.1	91.9	104.6	60.5	101.6	6.4	165.1	25.4	8	22.2	95.250	7.925	11.913	0.8	26.9	
in	2 1/2	9.62	1.62	4.12	4.88	2.88	4.12	1/4	7.50	1.12	8	1	R27	4.250	0.312	0.469	0.03	1.06
mm		244.3	41.1	104.6	124.0	73.2	104.6	6.4	190.5	28.4	8	25.4	107.950	7.925	11.913	0.8	26.9	
in	3	10.50	1.88	5.00	5.25	3.50	4.62	3/8	8.00	1.25	8	1 1/8	R35	5.375	0.312	0.469	0.03	1.06
mm		266.7	47.8	127.0	133.4	88.9	117.3	9.5	203.2	31.8	8	28.6	136.525	7.925	11.913	0.8	26.9	
in	4	12.25	2.12	6.19	6.38	4.50	4.88	1/2	9.50	1.38	8	1 1/4	R39	6.375	0.312	0.469	0.03	1.06
mm		311.2	53.8	157.2	162.1	114.3	124.0	12.7	241.3	35.1	8	31.8	161.925	7.925	11.913	0.8	26.9	
in	6	15.50	3.25	8.50	9.00	6.63	6.75	1/2	12.50	1.50	12	1 3/8	R46	8.312	0.375	0.531	0.06	1.12
mm		393.7	82.6	215.9	228.6	168.4	171.5	12.7	317.5	38.1	12	34.9	211.125	9.525	13.487	1.5	28.4	
in	8	19.00	3.62	10.62	11.50	8.63	8.38	1/2	15.50	1.75	12	1 5/8	
mm		482.6	91.9	269.7	292.1	219.2	212.9	12.7	393.7	44.5	12	41.3	
in	10	23.00	4.25	12.75	14.50	10.75	10.00	1/2	19.00	2.00	12	1 7/8	
mm		584.2	108.0	323.9	368.3	273.1	254.0	12.7	482.6	50.8	12	47.6	
in	12	26.50	4.88	15.00	17.75	12.75	11.12	1/2	22.50	2.12	16	2	
mm		673.1	124.0	381.0	450.9	323.9	282.4	12.7	571.5	53.8	16	50.8	
in	14	29.50	5.25	16.25	19.50	14.00	11.75	1/2	25.00	2.38	16	2 1/4	
mm		749.3	133.4	412.8	495.3	355.6	298.5	12.7	635.0	60.5	16	57.2	
in	16	32.50	5.75	18.50	21.75	16.00	12.25	1/2	27.80	2.60	16	2 1/2	
mm		825.5	146.1	469.9	552.1	406.4	311.2	12.7	704.9	66.5	16	63.5	
in	18	36.00	6.38	21.00	23.50	18.00	12.88	1/2	30.50	2.88	16	2 3/4	
mm		914.4	162.1	533.4	596.9	457.2	327.2	12.7	774.7	73.2	16	69.9	
in	20	38.75	7.00	23.00	25.25	20.00	14.00	1/2	32.75	3.12	16	3	
mm		984.3	177.8	584.2	641.4	508.0	355.6	12.7	831.9	79.2	16	76.2	
in	24	46.00	8.00	27.25	30.00	24.00	16.00	1/2	39.00	3.62	16	3 1/2	
mm		1168.4	203.2	692.2	762.0	609.6	406.4	12.7	990.6	91.9	16	88.9	

(1) Bore diameter to be specified by purchaser
 (2) Other NPT and SW connections available upon request

