

B16.47 Series A Class 600 Weld Neck & Blind

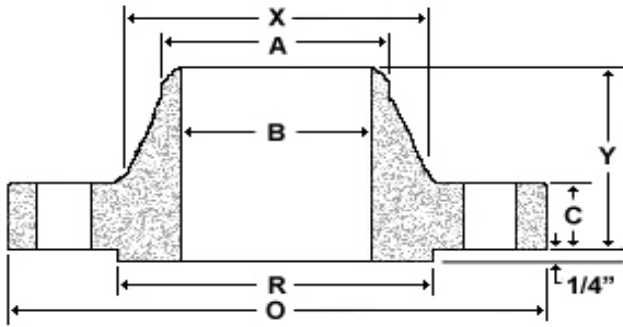

Weld Neck

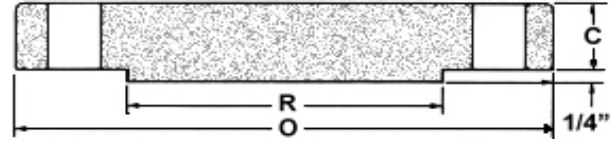

Blind

Nom Size	Thickness					Bore B	LTH Y	Dia Bevel A	Drilling				Weights	
	OD O	Weld Neck C	Blind C	OD of RF R	Dia at Base X				Bolt Circle	Bolt Length (1)	Hole Dia (2)	# of Holes	Weld Neck	Blind
26	40.00	4.25	4.94	29.50	29.44	To be specified by Purchaser.	8.75	26.00	36.00	14.50	2.00	28	940	1759
28	42.25	4.38	5.19	31.50	31.62		9.25	28.00	38.00	15.00	2.12	28	1060	2061
30	44.50	4.50	5.50	33.75	33.94		9.75	30.00	40.25	15.50	2.12	28	1210	2423
32	47.00	4.62	5.81	36.00	36.12		10.25	32.00	42.50	16.50	2.38	28	1375	2856
34	49.00	4.75	6.06	38.00	38.31		10.62	34.00	44.50	16.75	2.38	28	1540	3237
36	51.75	4.88	6.38	40.25	40.62		11.12	36.00	47.00	17.75	2.62	28	1705	3802
38	50.00	6.00	6.12	41.50	40.25		10.00	38.00	45.75	18.25	2.38	28	1470	3404
40	52.00	6.25	6.38	43.75	42.25		10.38	40.00	47.75	18.75	2.38	32	1630	3838
42	55.25	6.62	6.75	46.00	44.38		11.00	42.00	50.50	19.75	2.62	28	2030	4585
44	57.25	6.81	7.00	48.25	46.50		11.38	44.00	52.50	20.25	2.62	32	2160	5105
46	59.50	7.06	7.31	50.25	48.62		11.81	46.00	54.75	20.75	2.62	32	2410	5758
48	62.75	7.44	7.69	52.50	50.75		12.44	48.00	57.50	22.25	2.88	32	2855	6737
50	65.75	7.75	8.00	54.50	52.88		12.94	50.00	60.00	23.25	3.12	28	3330	7695
52	67.75	8.00	8.25	56.50	54.88		13.25	52.00	62.00	23.75	3.12	32	3560	8426
54	70.00	8.25	8.56	58.75	57.00		13.75	54.00	64.25	24.25	3.12	32	3920	9333
56	73.00	8.56	8.88	60.75	59.12		14.25	56.00	66.75	25.50	3.38	32	4280	10529
58	75.00	8.75	9.12	63.00	61.12		14.56	58.00	68.75	26.00	3.38	32	4640	11414
60	78.50	9.19	9.56	65.25	63.38		15.31	60.00	71.75	27.25	3.62	28	5000	13108

Dimensions are in inches. Weights are in pounds.

(1) Bolt lengths are calculated based on bolting one WN to one blind.

(2) Bolt diameter should be 1/8" less than the bolt hole diameter.

Note:

Larger sizes as well as intermediate sizes can be furnished.