

Slip-On Orifice Class 300

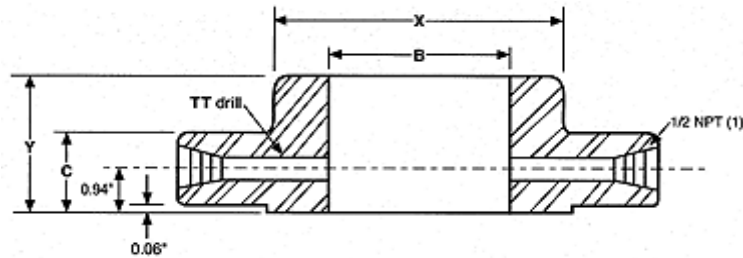

									Drilling			
	Nom Size	OD	Thickness	OD of RF	Dia at base	Bore	LTH	Dia of Pressure Connection	Bolt Circle	Hole Dia	# of holes	Bolt Dia
		O	C	R	X	B	Y	TT				
in	1	4.88	1.50	2.00	2.12	1.36	1.88	1/4	3.50	0.69	4	5/8
mm		124.0	38.1	50.8	53.8	34.5	47.8	6.4	88.9	17.5		15.9
in	1 1/2	6.12	1.50	2.88	2.75	1.95	1.88	1/4	4.50	0.81	4	3/4
mm		155.4	38.1	73.2	69.9	49.5	47.8	6.4	114.3	20.6		19.1
in	2	6.50	1.50	3.62	3.31	2.44	1.94	1/4	5.00	0.69	8	5/8
mm		165.1	38.1	91.9	84.1	62.0	49.3	6.4	127.0	17.5		15.9
in	2 1/2	7.50	1.50	4.12	3.94	2.94	2.00	1/4	5.88	0.81	8	3/4
mm		190.5	38.1	104.6	100.1	74.7	50.8	6.4	149.4	20.6		19.1
in	3	8.25	1.50	5.00	4.62	3.57	2.06	3/8	6.62	0.81	8	3/4
mm		209.6	38.1	127.0	117.3	90.7	52.3	9.5	168.1	20.6		19.1
in	4	10.00	1.50	6.19	5.75	4.57	2.12	1/2	7.88	0.81	8	3/4
mm		254.0	38.1	157.2	146.1	116.1	53.8	12.7	200.2	20.6		19.1
in	6	12.50	1.50	8.50	8.12	6.72	2.12	1/2	10.62	0.88	12	3/4
mm		317.5	38.1	215.9	206.2	170.7	53.8	12.7	269.7	22.4		19.1
in	8	15.00	1.62	10.62	10.25	8.72	2.44	1/2	13.00	1.00	12	7/8
mm		381.0	41.1	269.7	260.4	221.5	62.0	12.7	330.2	25.4		22.2
in	10	17.50	1.88	12.75	12.62	10.88	2.62	1/2	15.25	1.12	16	1
mm		444.5	47.8	323.9	320.5	276.4	66.5	12.7	387.4	28.4		25.4
in	12	20.50	2.00	15.00	14.75	12.88	2.88	1/2	17.75	1.25	16	1 1/8
mm		520.7	50.8	381.0	374.7	327.2	73.2	12.7	450.9	31.8		28.6
in	14	23.00	2.12	16.25	16.75	14.14	3.00	1/2	20.25	1.25	20	1 1/8
mm		584.2	53.8	412.8	425.5	359.2	76.2	12.7	514.4	31.8		28.6
in	16	25.50	2.25	18.50	19.00	16.16	3.25	1/2	22.50	1.38	20	1 1/4
mm		647.7	57.2	469.9	482.6	410.5	82.6	12.7	571.5	35.1		31.8
in	18	28.00	2.38	21.00	21.00	18.18	3.50	1/2	24.75	1.38	24	1 1/4
mm		711.2	60.5	533.4	533.4	461.8	88.9	12.7	628.7	35.1		31.8
in	20	30.50	2.50	23.00	23.12	20.20	3.75	1/2	27.00	1.38	24	1 1/4
mm		774.7	63.5	584.2	587.2	513.1	95.3	12.7	685.8	35.1		31.8
in	24	36.00	2.75	27.25	27.62	24.25	4.19	1/2	32.00	1.62	24	1 1/2
mm		914.4	69.9	692.2	701.5	616.0	106.4	12.7	812.8	41.1		38.1

1. Other NPT and SW connections available upon request.