

Industry Standard Class 75 Weld Neck & Blind

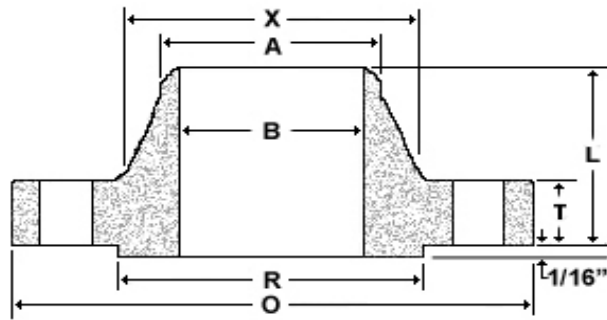

Weld Neck

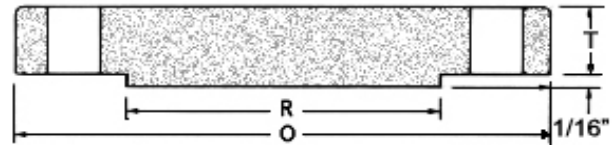

Blind

Nom Size	Thickness								Drilling				Weight	
	OD	Weld Neck	Blind	OD of RF	Dia at Base	Bore	LTH	Dia Bevel	Bolt Circle	Bolt Length ^a	Hole Dia ^b	# of Holes	Weld Neck	Blind
	O	T	T	R	X	B	L	A						
26	31.50	1.15	1.25	28.63	27.13	To be specified by Purchaser.	3.00	To be determined by design requirements.	29.63	5.00	1.00	32	98	265
28	33.50	1.25	1.25	30.63	29.13		3.00		31.63	5.00	1.00	36	105	300
30	35.50	1.25	1.38	32.63	31.13		3.00		33.63	5.25	1.00	36	110	370
32	38.25	1.25	1.50	35.00	33.38		3.25		36.16	5.50	1.13	36	140	470
34	40.25	1.25	1.50	37.00	35.38		3.25		38.13	5.50	1.13	40	150	520
36	42.25	1.25	1.63	39.00	37.38		3.25		40.13	5.75	1.13	40	160	620
42	49.00	1.25	1.88	45.50	43.75		3.50		46.75	6.25	1.25	48	210	970
48	55.00	1.25	2.13	51.50	49.75		3.75		52.75	6.50	1.25	52	240	1375
54	61.25	1.38	2.38	57.75	56.00		4.00		59.00	6.75	1.25	64	310	1925
60	67.25	1.63	2.63	63.75	62.00		4.38		65.00	7.25	1.25	72	400	2575
66	74.00	1.88	2.88	70.13	68.00	4.88	71.50	8.00	1.38	72	560	3400		
72	80.00	2.25	3.13	76.13	74.00	5.25	77.50	8.75	1.38	80	700	4350		

Dimensions are in inches. Weights are in pounds.

Note: Larger sizes as well as intermediate sizes can be furnished. When ordering Industry Standard Class 75 blinds specify if they are to be used with Weld Neck or Slip On flanges as the blinds differ between the two.

(a) Bolt lengths are calculated based on bolting one slip-on to one blind. Any other bolting combination will cause variance in bolt length.

(b) Bolt hole diameter 1/8in. larger than bolt diameter.