

# ANSI B16.5 Class 900 Forged Flanges

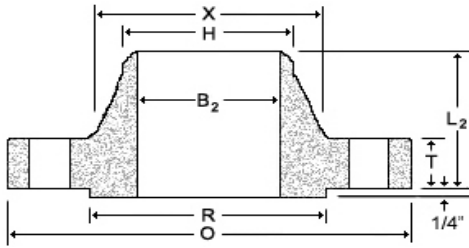

**Weld Neck**

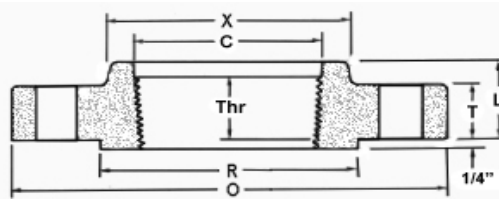

**Threaded**

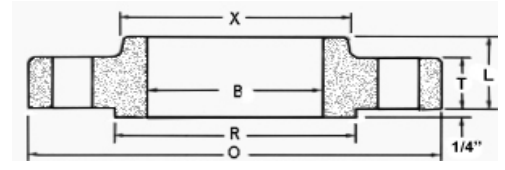

**Slip-On**

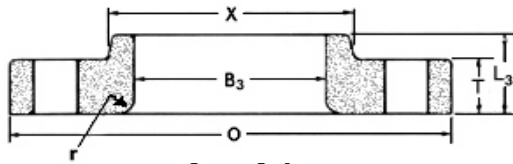

**Lap Joint**

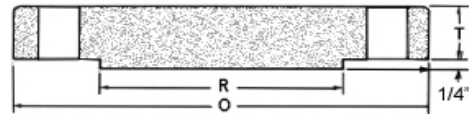

**Blind**

Nom. Pipe Size	O	T	R	X	#/Dia of Holes <sup>a</sup>	Bolt Circle Dia	B	B <sub>2</sub> <sup>b</sup>	B <sub>3</sub>	H	L	L <sub>2</sub>	L <sub>3</sub> <sup>c</sup>	r	C	Thr
Sizes 1/2" through 2 1/2" are identical to class 1500.																
3	9.50	1.50	5.00	5.00	8-1.00	7.50	3.57	<b>To be specified by Purchaser.</b>	3.60	3.50	2.12	4.00	2.12	0.38	3.63	1.62
4	11.50	1.75	6.19	6.25	8-1.25	9.25	4.57		4.60	4.50	2.75	4.50	2.75	0.44	4.63	1.88
5	13.75	2.00	7.31	7.50	8-1.38	11.00	5.66		5.69	5.56	3.12	5.00	3.12	0.44	5.69	2.12
6	15.00	2.19	8.50	9.25	12-1.25	12.50	6.72		6.75	6.63	3.38	5.50	3.38	0.50	6.75	2.25
8	18.50	2.50	10.63	11.75	12-1.50	15.50	8.72		8.75	8.63	4.00	6.38	4.50	0.50	8.75	2.50
10	21.50	2.75	12.75	14.50	16-1.50	18.50	10.88		10.92	10.75	4.25	7.25	5.00	0.50	10.88	2.81
12	24.00	3.12	15.00	16.50	20-1.50	21.00	12.88		12.92	12.75	4.63	7.88	5.62	0.50	12.94	3.00
14	25.25	3.38	16.25	17.75	20-1.63	22.00	14.14		14.18	14.00	5.12	8.38	6.12	0.50	14.19	3.25
16	27.75	3.50	18.50	20.00	20-1.75	24.25	16.16		16.19	16.00	5.25	8.50	6.50	0.50	16.19	3.38
18	31.00	4.00	21.00	22.25	20-2.00	27.00	18.18		18.20	18.00	6.00	9.00	7.50	0.50	18.19	3.50
20	33.75	4.25	23.00	24.50	20-2.13	29.50	20.20		20.25	20.00	6.25	9.75	8.25	0.50	20.19	3.62
24	41.00	5.50	27.25	29.50	20-2.63	35.50	24.25		24.25	24.00	8.00	11.50	10.50	0.50	24.19	4.00

*Dimensions are in inches.*

(a)- Bolt hole diameter 1/8 in. larger than bolt diameter.

(b)- See bore chart for wall thicknesses.

(c)- This dimension is commonly associated with "true" lap joints. Industry standard is to make to the slip on length through the hub.